

RESOLUTION NO. 741

A RESOLUTION APPROVING THE BID PROCESS, ACCEPTING THE LOW QUALIFIED BID; AWARDING THE CONTRACT TO THE LOW QUALIFIED BIDDER; VERIFYING FUND AVAILABILITY; AUTHORIZING THE EXPENDITURE OF FUNDS AND AUTHORIZING STAFF TO APPROVE ALL PAYMENTS FOR THE PROJECT KNOWN AS WILSONVILLE ROAD BIKEPATH PROJECT.

WHEREAS, bids were received prior to 1:00 p.m. Pacific Daylight Time, Monday, August 29, 1989, at Wilsonville City Hall, 30000 S.W. Town Center Loop East, Wilsonville, Oregon 97070. Bids were then opened individually and separately read aloud after 1:00 p.m. Pacific Daylight Time on August 29, 1989, and are listed in the attached Exhibit "A"; and

WHEREAS, the Wilsonville City Engineering Department has reviewed all bids received for completeness, additions and omissions; and

WHEREAS, the Community Development Director recommends the award of the contract for the Wilsonville Road Bikepath Project, for an amount not to exceed \$12,210.20; and

WHEREAS, the Finance Director has reviewed the fund to which expenditures will be accounted to, and has verified that funds are available to complete this project; and

NOW, THEREFORE, IT IS HEREBY RESOLVED by the City Council of the City of Wilsonville that:

1. The City Council acknowledges that all bids were received, publicly opened and approved as being completed for consideration for award according to the provisions of Oregon Revised Statutes 279.025, "Requirements of Advertisement".
2. The acceptance of the contract and awarding the contract to the lowest qualified bidder, as described in attachment "A".
3. Authorize the expenditure of funds for this contract from:

<u>ACCOUNT NO.</u>	<u>AMOUNT</u>
005-086-7136000	\$12,210.20

4. The Finance Director, by his signature below, has verified that funds are available in the account number mentioned in Item #3 above, for payment of all billings for this project.

Ray Shorten 9-6-89
Finance Director Date:

5. All change orders shall be approved by the City Council, prior to payment; all field changes shall be approved by the City Engineer, or duly authorized representative, prior to payment of field changes.

6. The final payment shall not be paid until the City Council has authorized said payment to be made.

ADOPTED by the City Council of the City of Wilsonville at a regular meeting thereof the 5th day of September, 1989 and filed with the Wilsonville City Recorder this same day.

John M. Ludlow
JOHN M. LUDLOW, Mayor

ATTEST:

Vera A. Rojas
VERA A. ROJAS, City Recorder

SUMMARY of Votes:

Mayor Ludlow AYE
Councilor Edwards AYE
Councilor Chandler ABSENT
Councilor Clarke AYE
Councilor Dant AYE



City of
WILSONVILLE
In OREGON

30000 SW Town Center Loop E • PO Box 220
Wilsonville, OR 97070
(503) 682-1011

ATTACHMENT "A"

BID OPENING - PHASE "B"
WILSONVILLE ROAD BIKEPATH PROJECT

August 29, 1989 - 1:00 p.m.

**WILSONVILLE CITY HALL
COUNCIL CHAMBERS
30000 S.W. TOWN CENTER LOOP E.
WILSONVILLE OR 97070**

Bids for Phase "B" of the Wilsonville Road Bikepath Project were publicly opened by Dee Staten, Senior Engineering Technician, in City Hall Council Chambers, at 1:27 p.m., on August 29, 1989.

Bid results for Phase "B" of the Bikepath Project were as follows:

1. Bob's Sanitary Service, Inc.
3011 SW Canby Street
Portland OR 97219

Bid Total - Phase "B" \$12,210.20

2. Bengé Construction
333 So. State St. Suite V-194
Lake Oswego OR 97034

Bid Total - Phase "B" \$13,495.50

The apparent low bidder was Bob's Sanitary Service, Inc., with a bid of \$12,210.20.

Kerr Associated Contractors, of 4380 SW Macadam, Suite 175, Portland OR 97201, bid on Phase "A" of the bikepath project for a total \$24,214.00. Kerr was disqualified due to the fact that they bid Phase "A" instead of Phase "B" of the project. Quantities were compared, and would have been approximately \$16,000.00 if applied to the Phase "B" portion of the bid.

dms:mld
cc: Project file



City of
WILSONVILLE
in OREGON

30000 SW Town Center Loop E • PO Box 220
Wilsonville, OR 97070
(503) 682-1011

COMMUNITY DEVELOPMENT DEPARTMENT
MEMORANDUM

DATE: AUGUST 30, 1989
TO: HONORABLE MAYOR AND CITY COUNCILORS
THROUGH: PETE WALL
CITY MANAGER
FROM: STEVE STARNER
COMMUNITY DEVELOPMENT DIRECTOR
RE: WILSONVILLE ROAD BIKEPATH PROJECT

The concept for this project originated in fiscal year 1988-89 as increasing numbers of school children from the Fox Chase and Rivergreen subdivisions began walking or riding bikes to the middle school and grade school. The Autumn Park project drew attention to the many children negotiating the narrow shoulder on Wilsonville Road near Willamette Way East; and the slow progress of the Valley Christian Church to begin the bikepath improvement as a required component of their overall project frustrated area residents and parents, (see exhibit no. 1). The City has received several "citizen concerns" related to the issue of pedestrian safety on Wilsonville Road in the vicinity of Willamette Way East.

In January, 1989, the Valley Christian Church indicated a willingness to proceed with a bikepath project if done in conjunction with a city bikepath improvement (between Willamette Way West and Willamette Way East, exhibit no. 2), and if the City would enter into an agreement to finance the entire project and allow the Church to reimburse the city's systems development fund over time. On that basis, the city engineering staff proceeded to survey, design, draw plans, and set out construction staking for the new bikepath, as delineated in two, distinct segments.

Based on the engineer's estimate, in June 1989, a selective bid process resulted in an average cost of \$19,717.00 for the city's portion of the bikepath. This cost exceeded the estimate by approximately 9.5 per cent. As a result of receiving high bids, the Church decided to proceed with their segment of the bikepath by drawing on resources within the Church and began construction in August, 1989, (see exhibit no. 3). The City has publicly advertised for bids on their segment of bikepath. As a result of the public bid the cost of \$12,210.20, submitted by Bob's Sanitary Service, Inc., is below the engineer's estimate by 31.5 per cent. This project was anticipated and budgeted within the '89 - '90 systems development improvement fund expenditure line item.

Honorable Mayor and City Councilors
Re: Wilsonville Road Bikepath Project
August 30, 1989 - Page 2

Recommendation:

In the interest of public safety, approve Resolution No. CB-R-412-89 and authorize the expenditure of \$12,210.20 from the systems development fund for the Wilsonville Road bikepath project.

ss:md

Attach: (3)

cc: Project file
Inter-Office Communications - CD

CITY OF



Wilsonville

30000 S.W. Town Center Loop E
P.O. Box 220 / Wilsonville, Oregon 97070-0220
503 / 682-1011

NOTICE OF DECISION

Proposed Development Action: Stage II Final Development Plans for Phase I of church.

PROJECT NAME: VALLEY CHRISTIAN CHURCH

CASE FILE NO: 87PC13

APPLICANT: Valley Christian Church
11711 S.W. Jamaica
Wilsonville, OR. 97070

OWNER: Valley Christian Church

PROPERTY DESCRIPTION:

Assessor Map No: T3S-R1W, Section 22

Tax Lot No: _____

Site Size: 4.5 acres

Address: _____

Location: South of Wood Middle School and east of Fox Chase I

Comprehensive Plan Designation: Residential

Zoning Designation: PDR - 7-12 du/ac

Existing Use: Vacant

On June 8, 1987, at the meeting of the Planning Commission the following FINAL ACTION was taken on the above-referenced Proposed Development action:

Approval Approval with Conditions Denial

The decision shall become effective eleven (11) days after the date of the decision, unless appealed in accordance with the provisions of Section 4.017 Wilsonville Code.

For further information, please contact Blaise Edmonds at the City of Wilsonville Planning Department - 682-1011.

Expiration Date: NA

Attachments:

- approved Resolution
- applicable Conditions, if any

Planning Commission

CONDITIONS OF APPROVAL

1. Provide two handicapped parking spaces in accordance with ANSI 117.1-1980. Locate handicapped parking within close proximity to the main entrance of the church.
2. Phase I parking shall include 75 parking spaces, including two parking spaces for handicapped use. All parking shall be conducted on site and not in the public right-of-way.
3. Construct an asphalt bikeway to match the existing bikeway along Wilsonville Road. The bikeway shall extend along the entire frontage of Phase I church development, which is the distance between Willametteway East and the church access to Wilsonville Road. The City strongly encourages the applicant to construct the bikeway along the entire length of the parcel.
4. Construct a five-foot wide curbside sidewalk along the entire length of the church parcel fronting Willametteway East.
5. Bikeway and sidewalk construction shall be completed at the time of final occupancy approval of Phase I church development. Coordinate with the City of Wilsonville Engineer for proper handicap design where the sidewalk and/or bikeway terminate at street intersections and driveways.
6. Off-street parking shall be constructed pursuant to Section 4.150 of the Development Code.
7. Dedicate public utility easements for all sewer, water and storm lines that cross or encroach any portion of the church site. Coordinate utility easement dedication with the City Engineer.
8. Stage I approval grants waiver relief to the 35-foot building height restriction and allows a maximum building height of 50 feet.
9. That the applicant waive right of remonstrance against the formation of any local improvement district which may be formed to serve the subject site.
10. The applicant shall conform with all requirements of the Tualatin Rural Fire District, but not limited to, circulation and location of fire hydrants.
11. The applicant shall conform with all requirements of the City's Engineering Department.

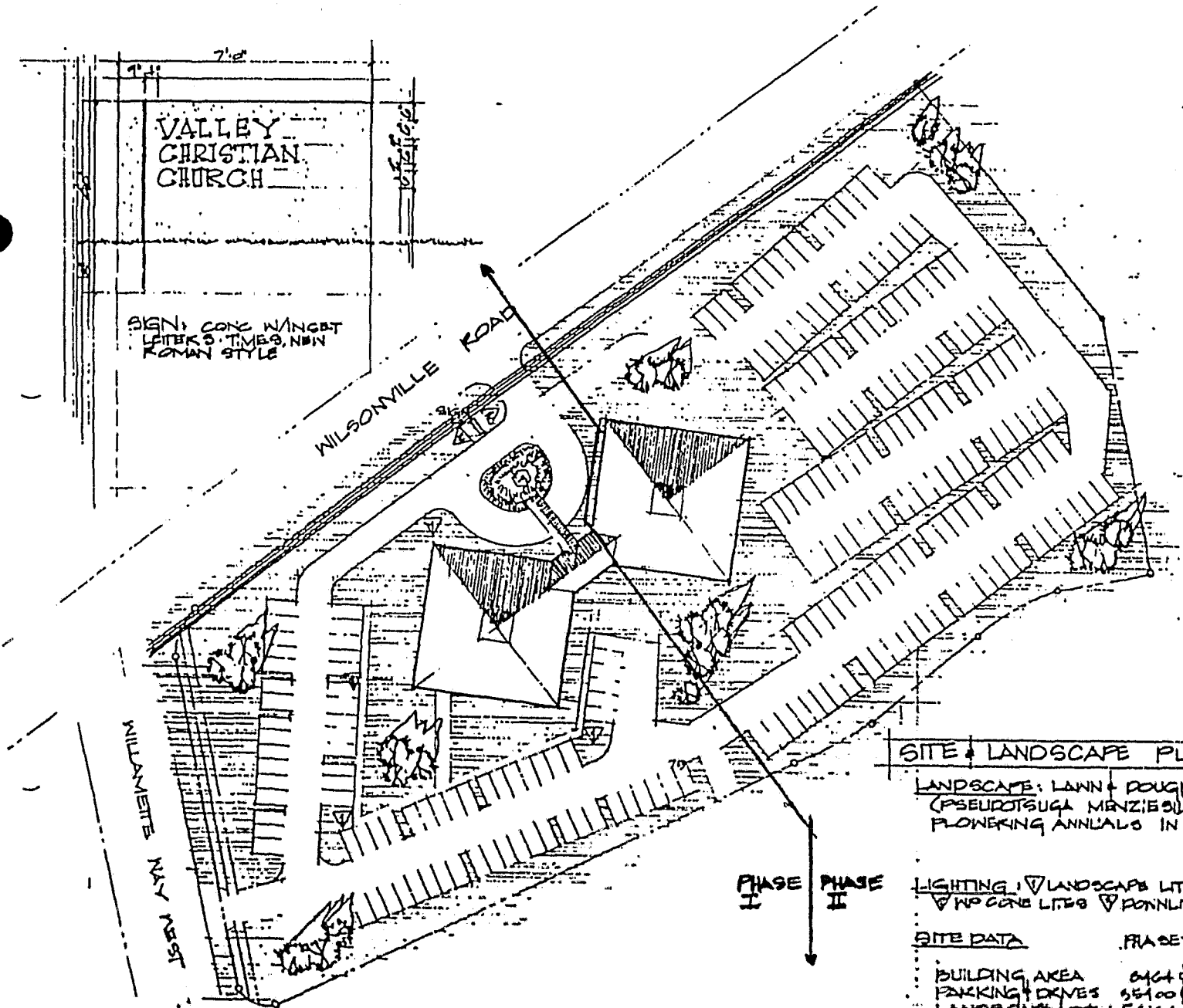

SITE & LANDSCAPE PLAN

LANDSCAPE: LAWN + DOUGLAS FIR 6'-8" - 22 QAN.
 (PSEUDOTSUGA MENZIESII),
 FLOWERING ANNUALS IN TURNAROUND (A)

LIGHTING: LANDSCAPE LITES SLOWER
 WOODS LITES DOWNLITES IN GOTTIT, 3 EA. SOB

SITE DATA	PHASE I		PHASE II	
	sq ft	%	sq ft	%
BUILDING AREA	8424	6%	8424	7%
PARKING + DRIVES	55100	46%	57000	47%
LANDSCAPE + OPEN	80150	67%	82000	67%
TOTAL SITE	126000		118,000	

PROVIDE SIDEWALK ON WILLAMETTE WAY WEST
 FIRE PATH ON WILSONVILLE RD

VALLEY CHRISTIAN CHURCH

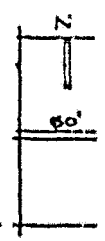

City of Wilsonville
CLACKAMAS CO.
Section 22

WILSONVILLE
ROAD
BIKEPATH

CITY LIMITS

CITY'S
RESPONSIBILITY

CHURCH'S
RESPONSIBILITY

AUTUMN PARK*
* (ALREADY
COMPLETED.)

*WOOD
MIDDLE SCHOOL

WILSONVILLE

WILSONVILLE

WILSONVILLE

WILSONVILLE

WILSONVILLE

WILSONVILLE

WILSONVILLE

WILSONVILLE

WILSONVILLE

WILSONVILLE

WILSONVILLE

WILSONVILLE

WILSONVILLE

WILSONVILLE

WILSONVILLE

WILSONVILLE

WILSONVILLE

WILSONVILLE

WILSONVILLE

WILSONVILLE

WILSONVILLE

WILSONVILLE

WILSONVILLE

WILSONVILLE

WILSONVILLE

WILSONVILLE

WILSONVILLE

WILSONVILLE

WILSONVILLE

WILSONVILLE

WILSONVILLE

WILSONVILLE

WILSONVILLE

WILSONVILLE

WILSONVILLE

WILSONVILLE

WILSONVILLE

WILSONVILLE

WILSONVILLE

WILSONVILLE

WILSONVILLE

WILSONVILLE

WILSONVILLE

WILSONVILLE

WILSONVILLE

1/4 Sec.
map page
8a

1/4 Sec.
map
8b

1/4 Sec.
map page
8c

90018

10728 10668

10660

10400

10660

30840

10830

10990

10840

10838

15 14

22 23

BROWN ROAD

ROAD

OAKLEAF

OAKLEAF

OAKLEAF

OAKLEAF

OAKLEAF

OAKLEAF

OAKLEAF

OAKLEAF

OAKLEAF

OAKLEAF

OAKLEAF

OAKLEAF

OAKLEAF

OAKLEAF

OAKLEAF

OAKLEAF

next map
page 9

RIVER

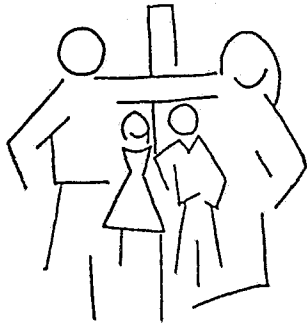

VALLEY CHRISTIAN CHURCH

11188 S.W. Wilsonville Rd.
P.O. Box 506
Wilsonville, Oregon 97070
(503) 682-3693

May 15, 1989

Steven E. Starner
CITY OF WILSONVILLE
30000 SW Town Center Loop E -- P.O. Box 220
Wilsonville, OR 97070-0220

Re: Construction of Wilsonville Road Bikepath

Dear Mr. Starner:

The trustees of Valley Christian Church have been awaiting your reply about the construction of the bikepath. We are as anxious to get started on this project as you are. We believe we have enough funds for the first phase of development bikepath.

We are ready to enter into an agreement with the city for the payback on Phase II as an accommodation to the safety hazard created by in-completion.

We understand, according to the engineer's estimate, that our portion of the project comes to approximately \$6,193. It is realized that this is only an estimate, subject to the bids received on June 19. If the bid is more than expected, we would request notification for further deliberation.

Sincerely,

Phil A. Poole
Chairman of Trustees

pap:dr

WHERE EVERYBODY IS SOMEBODY
AND JESUS IS LORD